



The first and last.

Proud to announce
Bellini at Williams Island.

The **first** pre-construction development
to break ground in South Florida in 2011.

The **last** residential site on Williams Island.

a Martin Z Margulies Development

Floor Plan | UNIT A

3 BEDROOMS, 3.5 BATHROOMS

2,608 SF / 242 M² LIVING AREA

610 SF / 56 M² BALCONIES

TOTAL = 3,218 SF / 298 SM

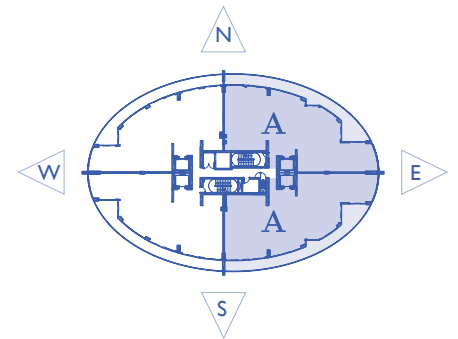

A - North



A - South



*All dimensions, specifications and features are approximate and subject to change without notice.

B - North



B - South



Floor Plan | UNIT B

3 BEDROOMS, 3 BATHROOMS

2,235 SF / 208 M² LIVING AREA

523 SF / 48 M² BALCONIES

TOTAL = 2,758 SF / 256 SM

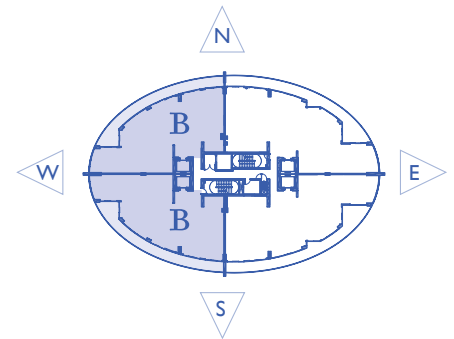
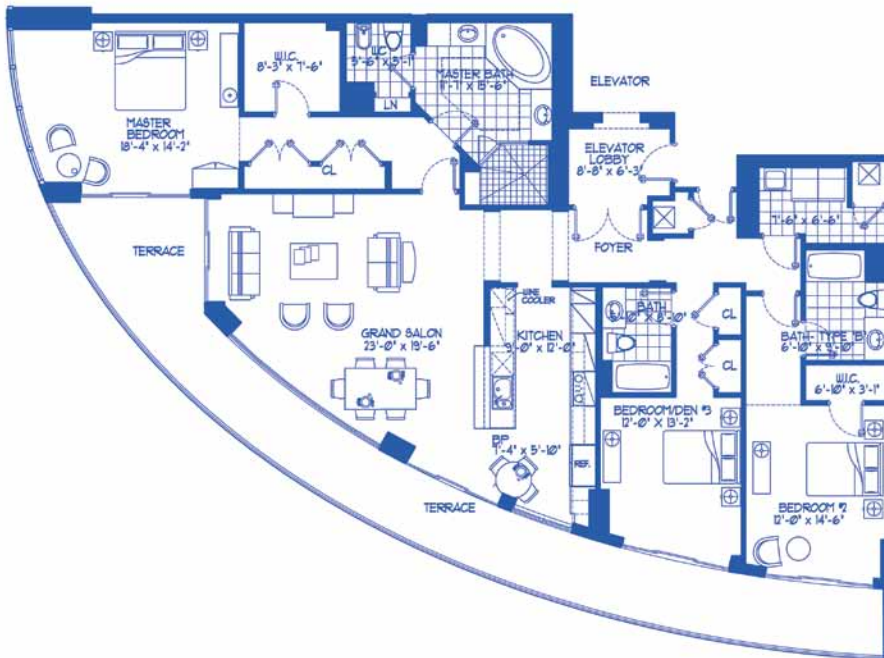

*All dimensions, specifications and features are approximate and subject to change without notice.

Floor Plan | PENTHOUSE A

4 BEDROOMS, 6.5 BATHROOMS

4,955 SF / 460 M² LIVING AREA

1,150 SF / 107 M² BALCONIES

TOTAL = 6,105 SF / 567 SM

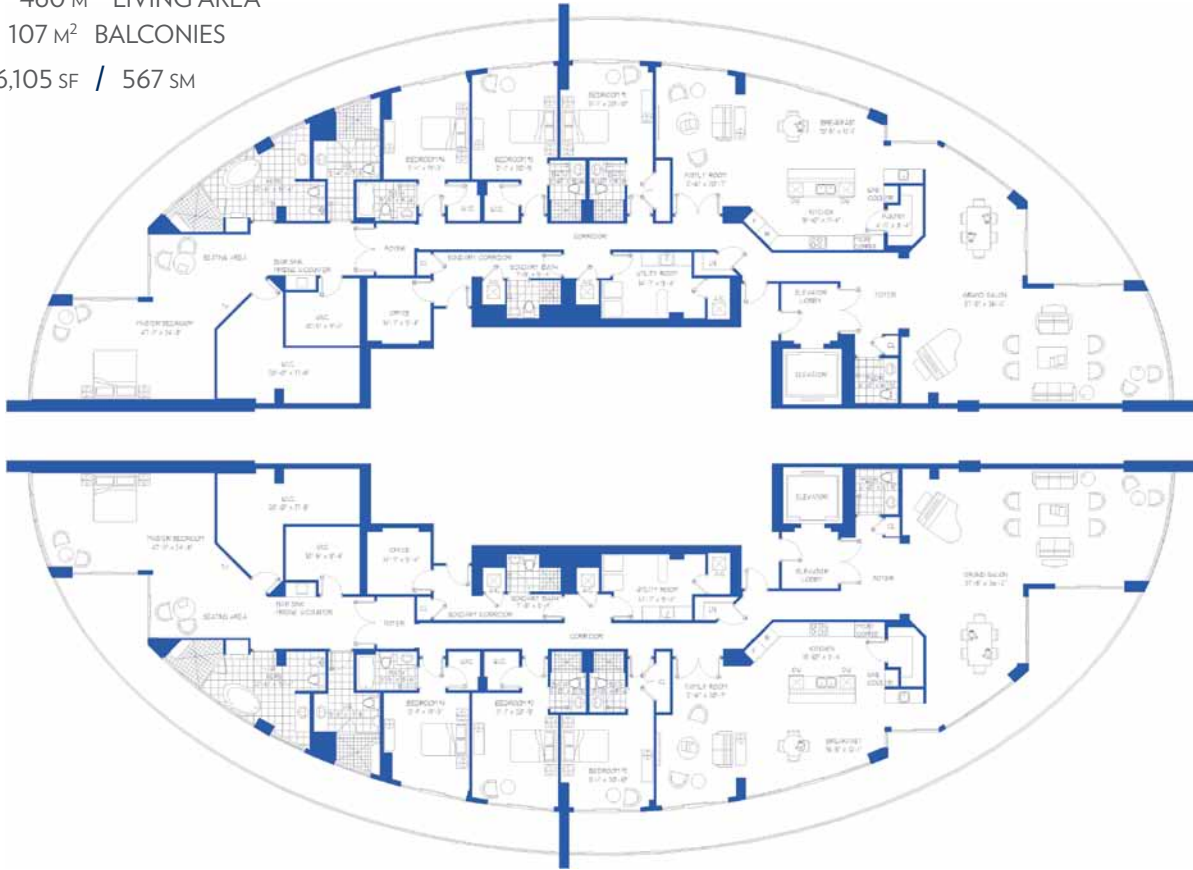

Floor Plan | PENTHOUSE B

4 BEDROOMS, 6.5 BATHROOMS

4,955 SF / 460 M² LIVING AREA

1,150 SF / 107 M² BALCONIES

TOTAL = 6,105 SF / 567 SM

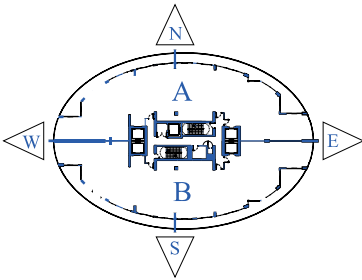

Aerial View



Martin Z. Margulies

A developer responsible for South Florida's most prestigious residences.

Martin Z. Margulies has three decades of high-end condominium construction to their credit. Included in the portfolio are such notable residences as Grove Isle, Bellini Bal Harbour, and Grand Bay Towers Key Biscayne.

Mr. Margulies is recognized for the personal attention he devotes to every one of his condominium developments. The architecture, interior design, landscaping and recreation all attest to his uncompromising nature and total commitment to quality and good taste. Residents also benefit from the fact that Mr. Margulies is recognized as one of the leading collectors of contemporary art in the world. His aesthetic sensibilities will be reflected in all the elegant furnishings and flourishes that will bring a fresh new sense of style to the glamorous Williams Island lifestyle.

Grand Bay - Key Biscayne



Grove Isle - Coconut Grove





BELLINI WILLIAMS ISLAND

4100 Williams Island Boulevard
Aventura, Florida 33160

belliniwilliamsisland.com

This material is based upon information that we consider reliable, but because it has been supplied by third parties, we cannot represent that it is accurate or complete, and it should not be relied upon as such. This offering is subject to errors, omissions, changes, including price, or withdrawal without notice. ©MMXI Sotheby's International Realty Affiliates LLC. All Rights Reserved. Sotheby's International Realty® is a licensed trademark to Sotheby's International Realty Affiliates LLC. An Equal Opportunity Company. Equal Housing Opportunity. Each Office Is Independently Owned And Operated.