

# A 2

4 BEDROOMS  
 5 BATHROOMS  
 2 POWDER ROOMS  
 DEN / SERVICE  
 OFFICE / GYM

INTERIOR  
 4,784 SF | 444 SQM

EXTERIOR  
 380 SF | 35 SQM

TOTAL  
 5,164 SF | 479 SQM

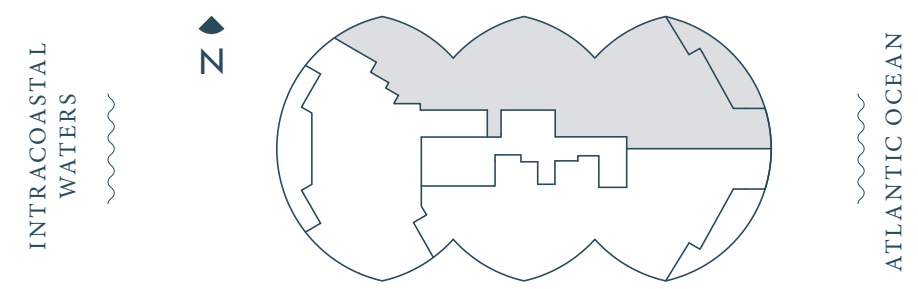
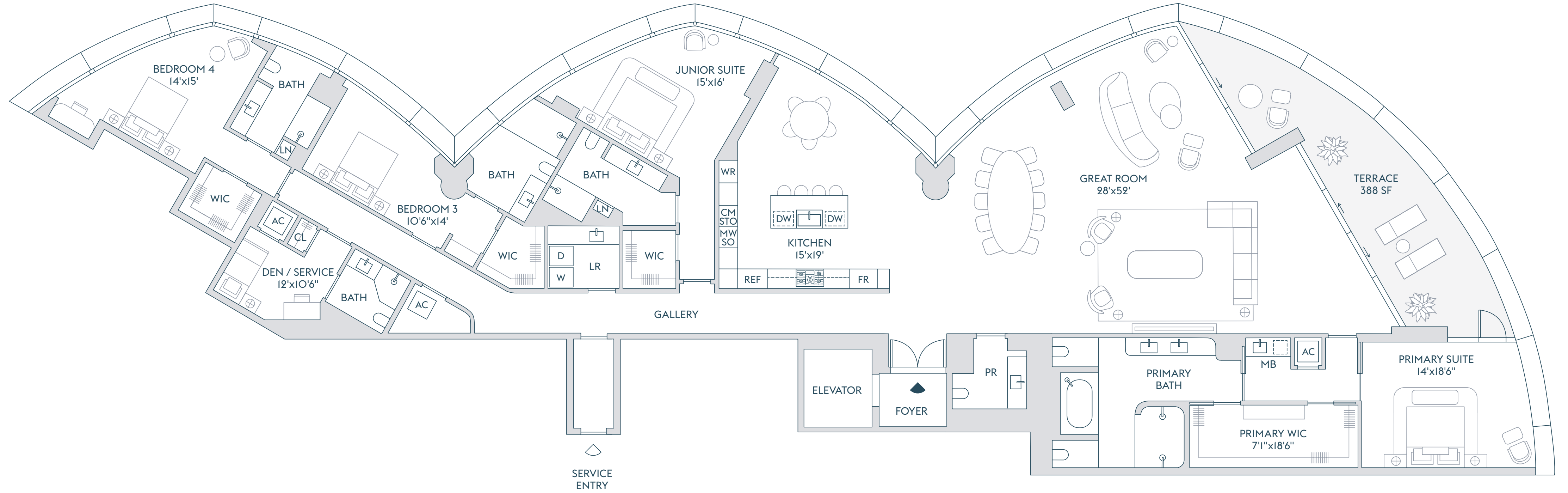

The dimensions stated for this Unit floor plan are approximate because there are various recognized methods for calculating the square footage of a Unit. The square footage stated herein is calculated from the exterior boundaries of the exterior walls to the centerline of interior demising walls without deductions for cutouts, curves, or architectural features. This method typically results in quoted dimensions greater than the dimensions that would be determined by using other accepted methods. The definition of "Unit" and the calculation method to be relied upon is the method of calculation set forth by the Developer in the Developer's prospectus, which method may result in a square footage calculation that is less than the method used herein. Dimensions and Unit configurations are not guaranteed and may change during construction. Depictions of furnishings, fixtures, and other items of personal property are not included with purchase. Uses of space depicted are not guaranteed. Consult the Developer's prospectus to learn Unit dimensions, what is offered with the Unit, and all terms and conditions. 2022 © Carlton Terrace Owner LLC, with all rights reserved.

# A 3-17

4 BEDROOMS  
 5 BATHROOMS  
 2 POWDER ROOMS  
 DEN / SERVICE  
 OFFICE / GYM

INTERIOR  
 4,810 SF | 446.5 SQM

EXTERIOR  
 380 SF | 35 SQM

TOTAL  
 5,190 SF | 481.5 SQM

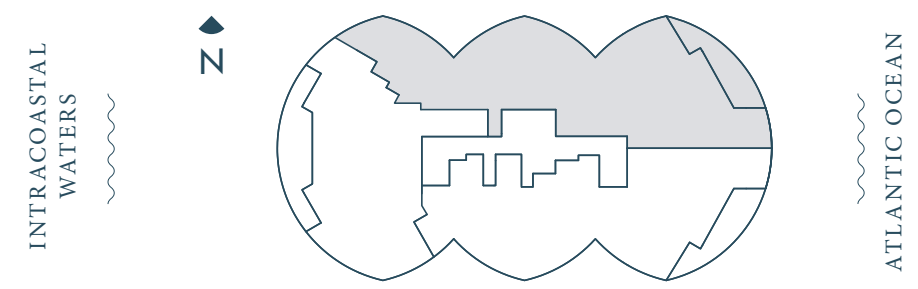
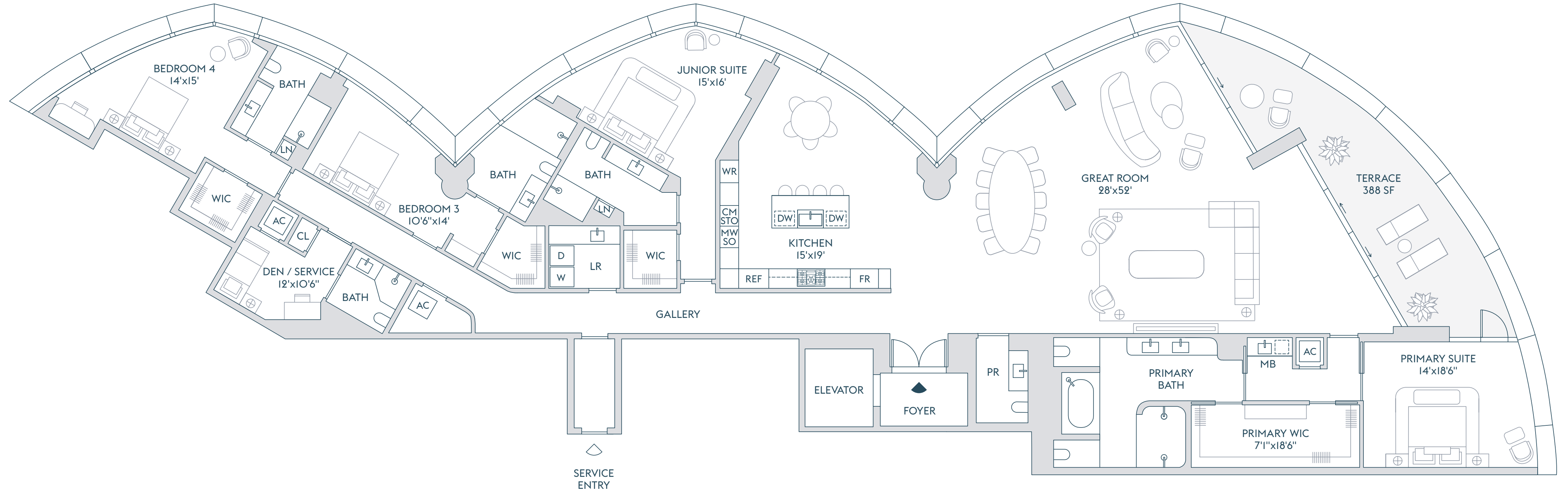

The dimensions stated for this Unit floor plan are approximate because there are various recognized methods for calculating the square footage of a Unit. The square footage stated herein is calculated from the exterior boundaries of the exterior walls to the centerline of interior demising walls without deductions for cutouts, curves, or architectural features. This method typically results in quoted dimensions greater than the dimensions that would be determined by using other accepted methods. The definition of "Unit" and the calculation method to be relied upon is the method of calculation set forth by the Developer in the Developer's prospectus, which method may result in a square footage calculation that is less than the method used herein. Dimensions and Unit configurations are not guaranteed and may change during construction. Depictions of furnishings, fixtures, and other items of personal property are not included with purchase. Uses of space depicted are not guaranteed. Consult the Developer's prospectus to learn Unit dimensions, what is offered with the Unit, and all terms and conditions. 2022 © Carlton Terrace Owner LLC, with all rights reserved.

# B 2

4 BEDROOMS  
 5 BATHROOMS  
 1 POWDER ROOM  
 DEN / SERVICE

INTERIOR  
 4,215 SF | 391.5 SQM

EXTERIOR  
 387 SF | 36 SQM

TOTAL  
 4,602 SF | 427.5 SQM

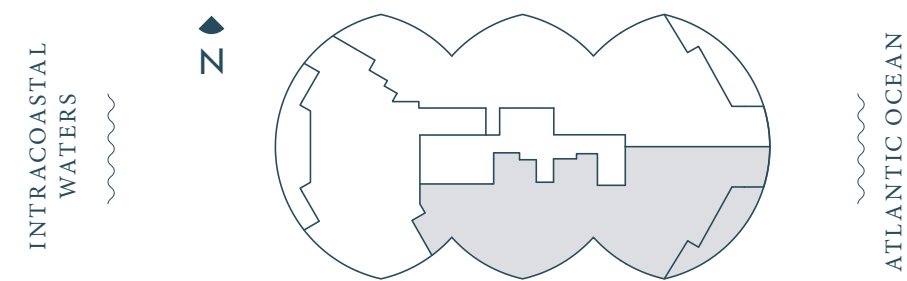
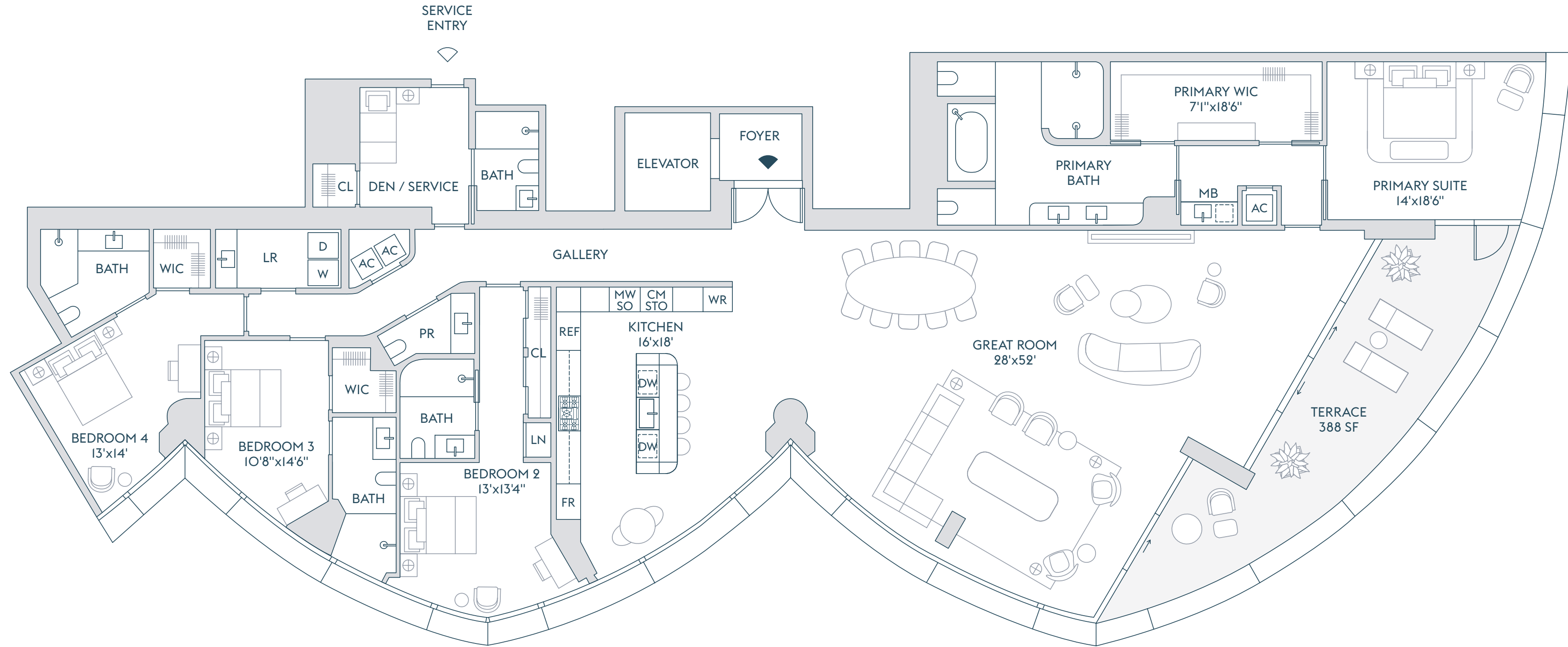

The dimensions stated for this Unit floor plan are approximate because there are various recognized methods for calculating the square footage of a Unit. The square footage stated herein is calculated from the exterior boundaries of the exterior walls to the centerline of interior demising walls without deductions for cutouts, curves, or architectural features. This method typically results in quoted dimensions greater than the dimensions that would be determined by using other accepted methods. The definition of "Unit" and the calculation method to be relied upon is the method of calculation set forth by the Developer in the Developer's prospectus, which method may result in a square footage calculation that is less than the method used herein. Dimensions and Unit configurations are not guaranteed and may change during construction. Depictions of furnishings, fixtures, and other items of personal property are not included with purchase. Uses of space depicted are not guaranteed. Consult the Developer's prospectus to learn Unit dimensions, what is offered with the Unit, and all terms and conditions. 2022 © Carlton Terrace Owner LLC, with all rights reserved.

# B 3-17

4 BEDROOMS  
 5 BATHROOMS  
 1 POWDER ROOM  
 DEN / SERVICE

INTERIOR  
 4,358 SF | 404.5 SQM

EXTERIOR  
 387 SF | 36 SQM

TOTAL  
 4,745 SF | 440.5 SQM

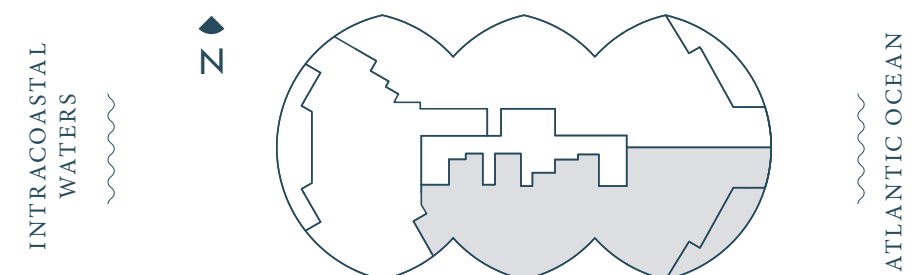
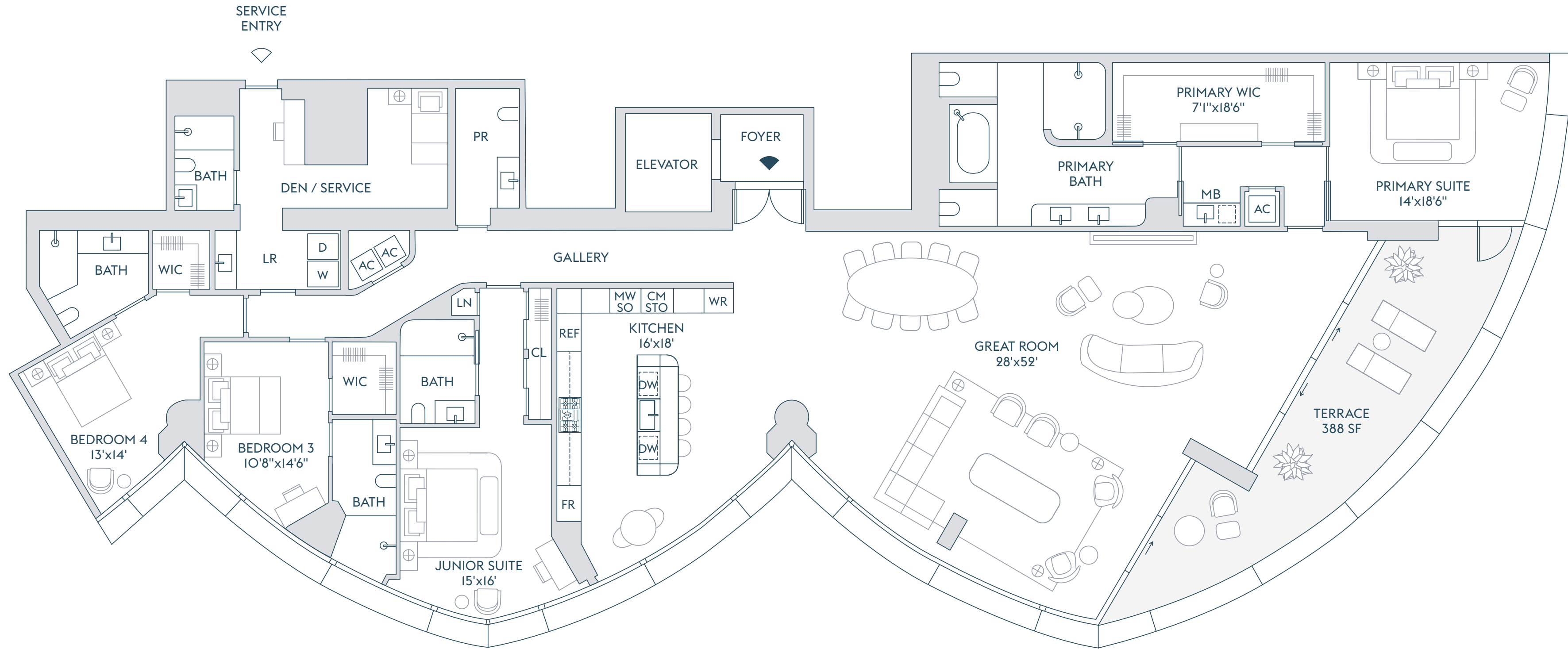

The dimensions stated for this Unit floor plan are approximate because there are various recognized methods for calculating the square footage of a Unit. The square footage stated herein is calculated from the exterior boundaries of the exterior walls to the centerline of interior demising walls without deductions for cutouts, curves, or architectural features. This method typically results in quoted dimensions greater than the dimensions that would be determined by using other accepted methods. The definition of "Unit" and the calculation method to be relied upon is the method of calculation set forth by the Developer in the Developer's prospectus, which method may result in a square footage calculation that is less than the method used herein. Dimensions and Unit configurations are not guaranteed and may change during construction. Depictions of furnishings, fixtures, and other items of personal property are not included with purchase. Uses of space depicted are not guaranteed. Consult the Developer's prospectus to learn Unit dimensions, what is offered with the Unit, and all terms and conditions. 2022 © Carlton Terrace Owner LLC, with all rights reserved.



RESIDENCE FLOOR

# C 2

3 BEDROOMS  
3 BATHROOMS  
1 POWDER ROOM  
OFFICE / DEN

INTERIOR  
3,284 SF | 305 SQM

EXTERIOR  
585 SF | 54 SQM

TOTAL  
3,869 SF | 359 SQM

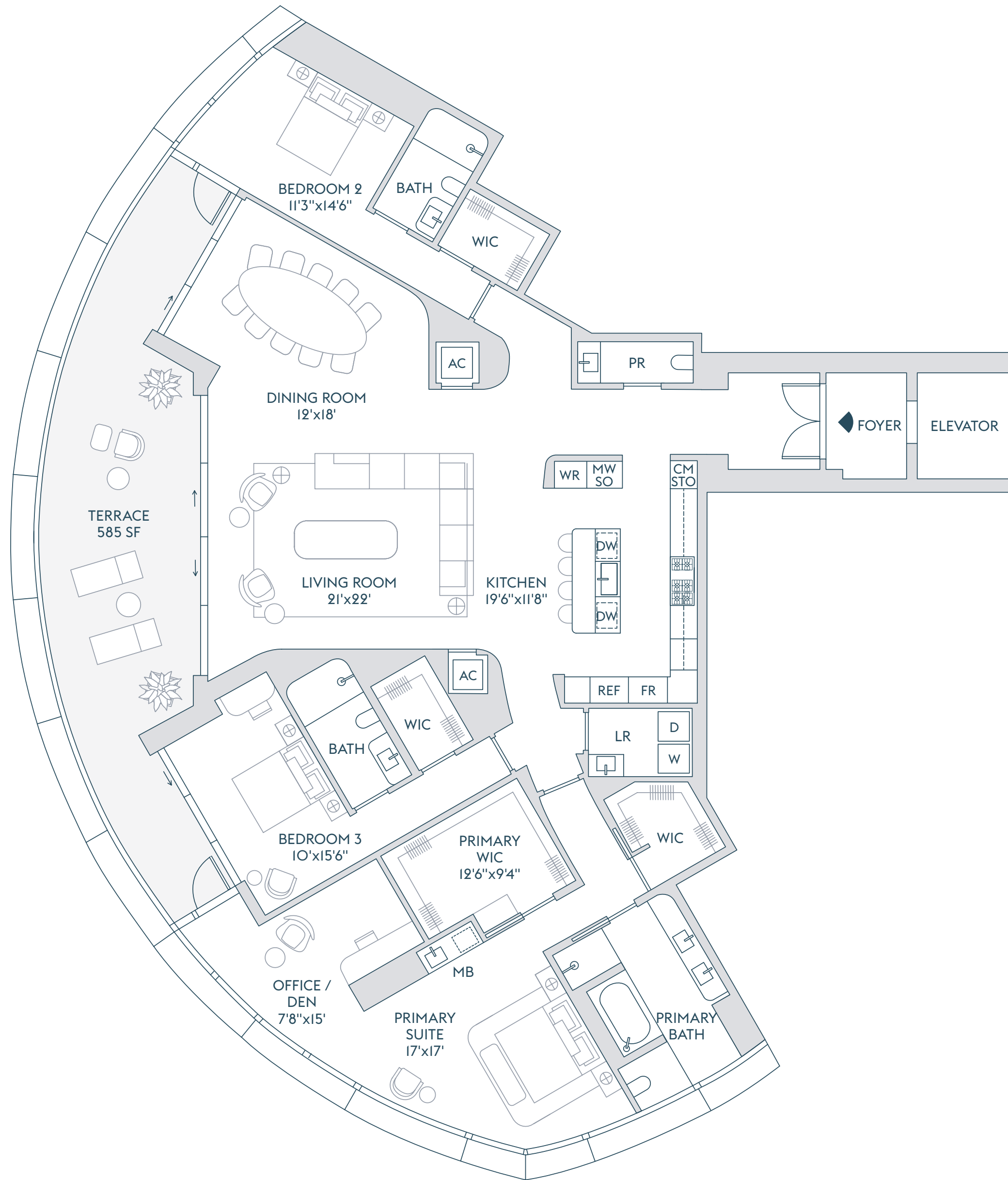

INTRACOASTAL  
WATERS

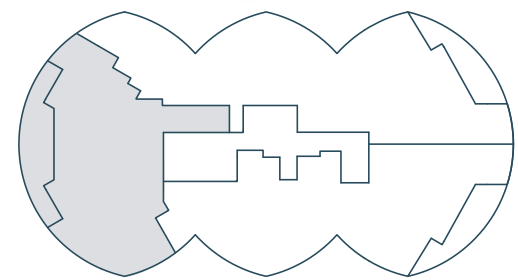

ATLANTIC OCEAN

The dimensions stated for this Unit floor plan are approximate because there are various recognized methods for calculating the square footage of a Unit. The square footage stated herein is calculated from the exterior boundaries of the exterior walls to the centerline of interior demising walls without deductions for cutouts, curves, or architectural features. This method typically results in quoted dimensions greater than the dimensions that would be determined by using other accepted methods. The definition of "Unit" and the calculation method to be relied upon is the method of calculation set forth by the Developer in the Developer's prospectus, which method may result in a square footage calculation that is less than the method used herein. Dimensions and Unit configurations are not guaranteed and may change during construction. Depictions of furnishings, fixtures, and other items of personal property are not included with purchase. Uses of space depicted are not guaranteed. Consult the Developer's prospectus to learn Unit dimensions, what is offered with the Unit, and all terms and conditions. 2022 © Carlton Terrace Owner LLC, with all rights reserved.

RESIDENCE FLOORS

# C 3-17

3 BEDROOMS  
3 BATHROOMS  
1 POWDER ROOM  
OFFICE / DEN

INTERIOR  
3,297 SF | 306.5 SQM

EXTERIOR  
585 SF | 54 SQM

TOTAL  
3,882 SF | 360.5 SQM

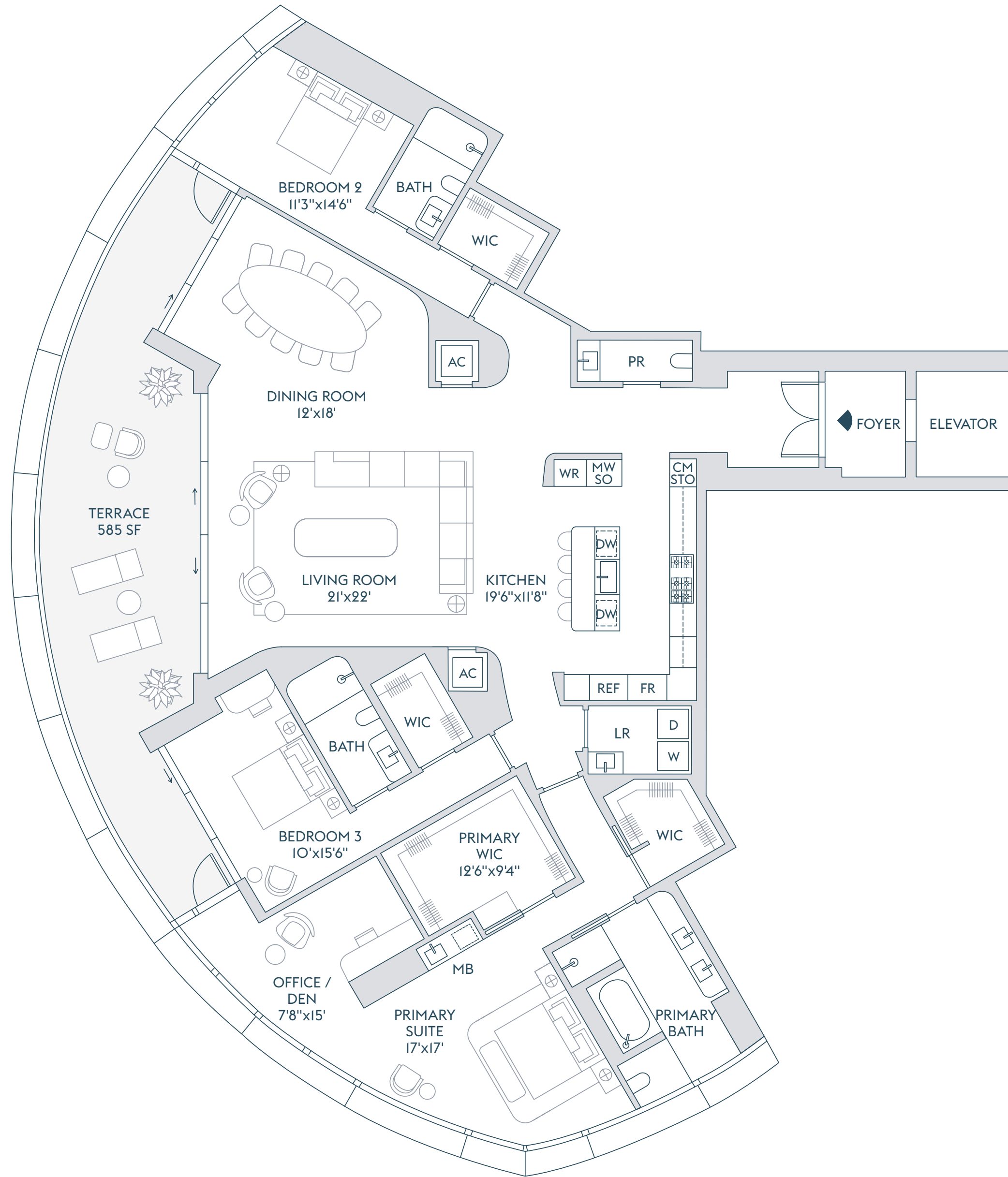

INTRACOASTAL  
WATERS

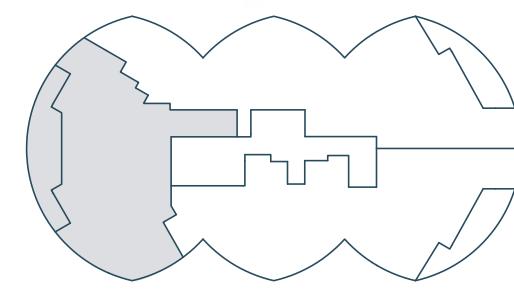

ATLANTIC OCEAN

The dimensions stated for this Unit floor plan are approximate because there are various recognized methods for calculating the square footage of a Unit. The square footage stated herein is calculated from the exterior boundaries of the exterior walls to the centerline of interior demising walls without deductions for cutouts, curves, or architectural features. This method typically results in quoted dimensions greater than the dimensions that would be determined by using other accepted methods. The definition of "Unit" and the calculation method to be relied upon is the method of calculation set forth by the Developer in the Developer's prospectus, which method may result in a square footage calculation that is less than the method used herein. Dimensions and Unit configurations are not guaranteed and may change during construction. Depictions of furnishings, fixtures, and other items of personal property are not included with purchase. Uses of space depicted are not guaranteed. Consult the Developer's prospectus to learn Unit dimensions, what is offered with the Unit, and all terms and conditions. 2022 © Carlton Terrace Owner LLC, with all rights reserved.

# A 18-21

- 4 BEDROOMS
- 6 BATHROOMS
- POWDER ROOM
- OFFICE / BEDROOM
- FAMILY ROOM
- DEN
- SERVICE

INTERIOR  
6,655 SF | 618 SQM

EXTERIOR  
876 SF | 81 SQM

TOTAL  
7,531 SF | 700 SQM

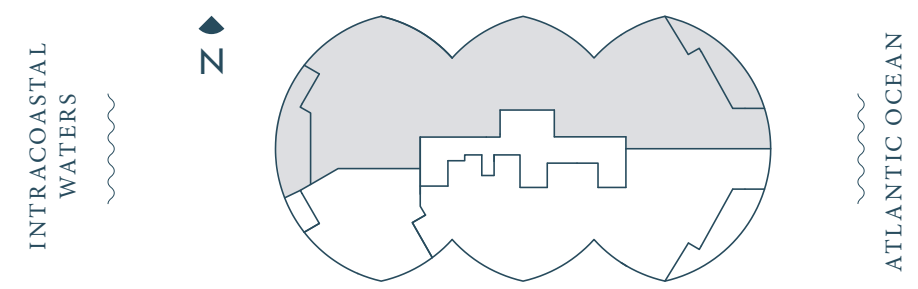
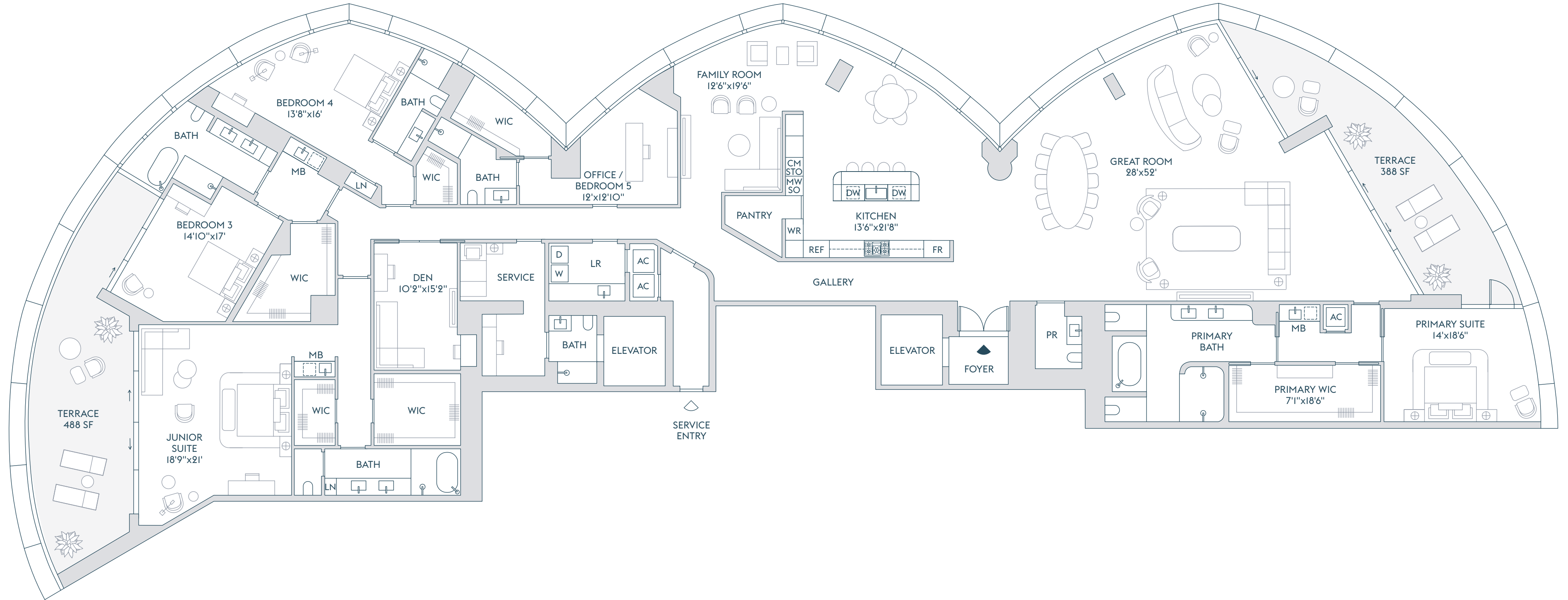

The dimensions stated for this Unit floor plan are approximate because there are various recognized methods for calculating the square footage of a Unit. The square footage stated herein is calculated from the exterior boundaries of the exterior walls to the centerline of interior demising walls without deductions for cutouts, curves, or architectural features. This method typically results in quoted dimensions greater than the dimensions that would be determined by using other accepted methods. The definition of "Unit" and the calculation method to be relied upon is the method of calculation set forth by the Developer in the Developer's prospectus, which method may result in a square footage calculation that is less than the method used herein. Dimensions and Unit configurations are not guaranteed and may change during construction. Depictions of furnishings, fixtures, and other items of personal property are not included with purchase. Uses of space depicted are not guaranteed. Consult the Developer's prospectus to learn Unit dimensions, what is offered with the Unit, and all terms and conditions. 2022 © Carlton Terrace Owner LLC, with all rights reserved.



RESIDENCE

FLOORS

# B

# 18-21

- 4 BEDROOMS
- 6 BATHROOMS
- POWDER ROOM
- OFFICE / BEDROOM
- FAMILY ROOM
- DEN
- SERVICE

INTERIOR  
5,810 SF | 540 SQM

EXTERIOR  
485 SF | 45 SQM

TOTAL  
6,295 SF | 585 SQM

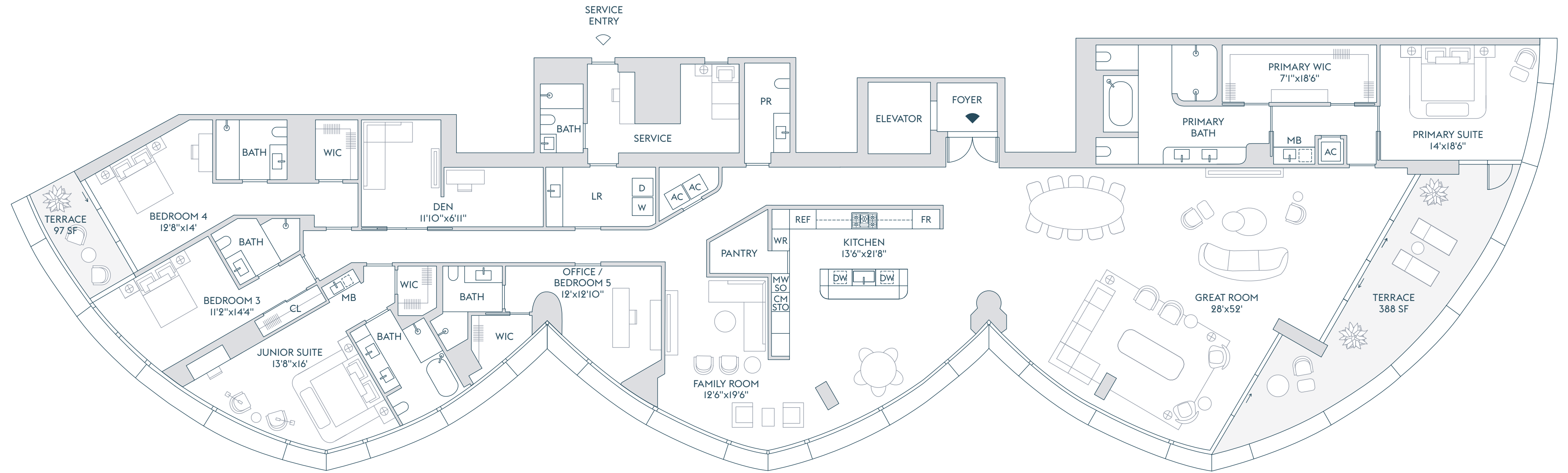

INTRACOASTAL WATERS

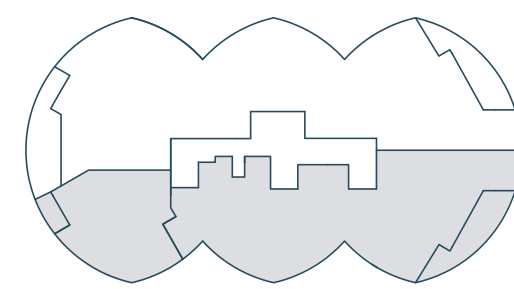

ATLANTIC OCEAN

The dimensions stated for this Unit floor plan are approximate because there are various recognized methods for calculating the square footage of a Unit. The square footage stated herein is calculated from the exterior boundaries of the exterior walls to the centerline of interior demising walls without deductions for cutouts, curves, or architectural features. This method typically results in quoted dimensions greater than the dimensions that would be determined by using other accepted methods. The definition of "Unit" and the calculation method to be relied upon is the method of calculation set forth by the Developer in the Developer's prospectus, which method may result in a square footage calculation that is less than the method used herein. Dimensions and Unit configurations are not guaranteed and may change during construction. Depictions of furnishings, fixtures, and other items of personal property are not included with purchase. Uses of space depicted are not guaranteed. Consult the Developer's prospectus to learn Unit dimensions, what is offered with the Unit, and all terms and conditions. 2022 © Carlton Terrace Owner LLC, with all rights reserved.



# A 23, 24, 25

- 5 BEDROOMS
- 7 BATHROOMS
- 3 POWDER ROOMS
- DEN / SERVICE
- MEDIA ROOM
- GAME ROOM
- LIBRARY / LOUNGE
- FITNESS STUDIO
- OUTDOOR KITCHEN
- POOL
- PRIVATE ELEVATOR

INTERIOR  
12,603 SF | 1,171 SQM

EXTERIOR  
4,918 SF | 457 SQM

TOTAL  
17,521 SF | 1,628 SQM

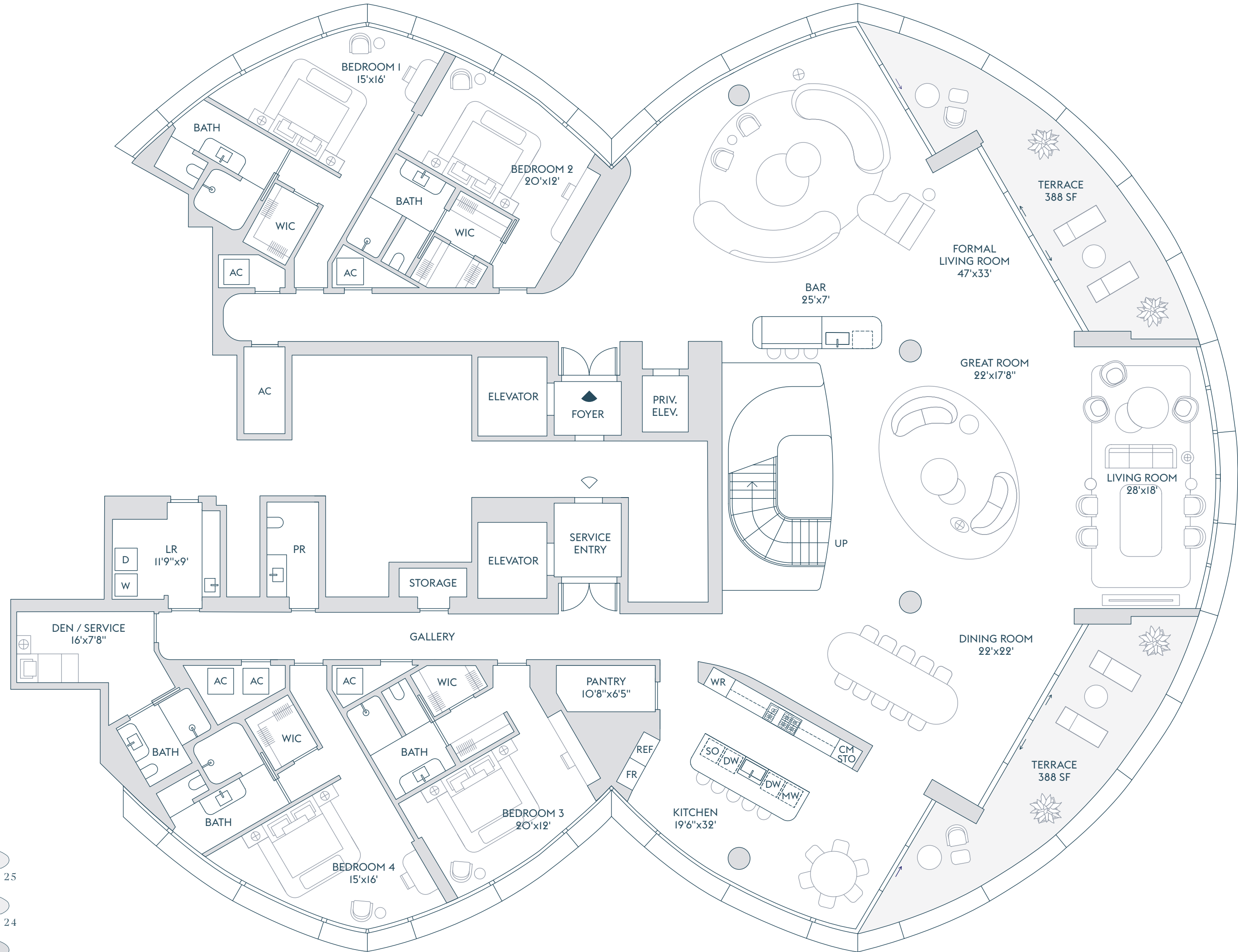

INTRACOASTAL  
WATERS

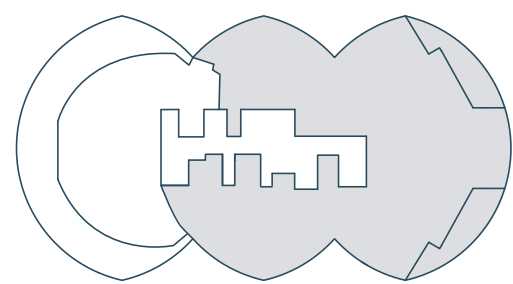

ATLANTIC OCEAN

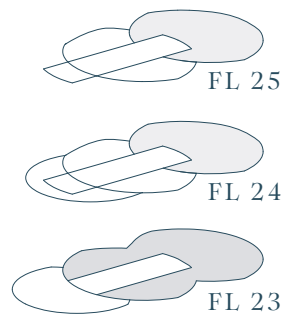

## FLOOR 23

The dimensions stated for this Unit floor plan are approximate because there are various recognized methods for calculating the square footage of a Unit. The square footage stated herein is calculated from the exterior boundaries of the exterior walls to the centerline of interior demising walls without deductions for cutouts, curves, or architectural features. This method typically results in quoted dimensions greater than the dimensions that would be determined by using other accepted methods. The definition of "Unit" and the calculation method to be relied upon is the method of calculation set forth by the Developer in the Developer's prospectus, which method may result in a square footage calculation that is less than the method used herein. Dimensions and Unit configurations are not guaranteed and may change during construction. Depictions of furnishings, fixtures, and other items of personal property are not included with purchase. Uses of space depicted are not guaranteed. Consult the Developer's prospectus to learn Unit dimensions, what is offered with the Unit, and all terms and conditions. 2022 © Carlton Terrace Owner LLC, with all rights reserved.

# A 23, 24, 25

- 5 BEDROOMS
- 7 BATHROOMS
- 3 POWDER ROOMS
- DEN / SERVICE
- MEDIA ROOM
- GAME ROOM
- LIBRARY / LOUNGE
- FITNESS STUDIO
- OUTDOOR KITCHEN
- POOL
- PRIVATE ELEVATOR

INTERIOR  
12,603 SF | 1,171 SQM

EXTERIOR  
4,918 SF | 457 SQM

TOTAL  
17,521 SF | 1,628 SQM

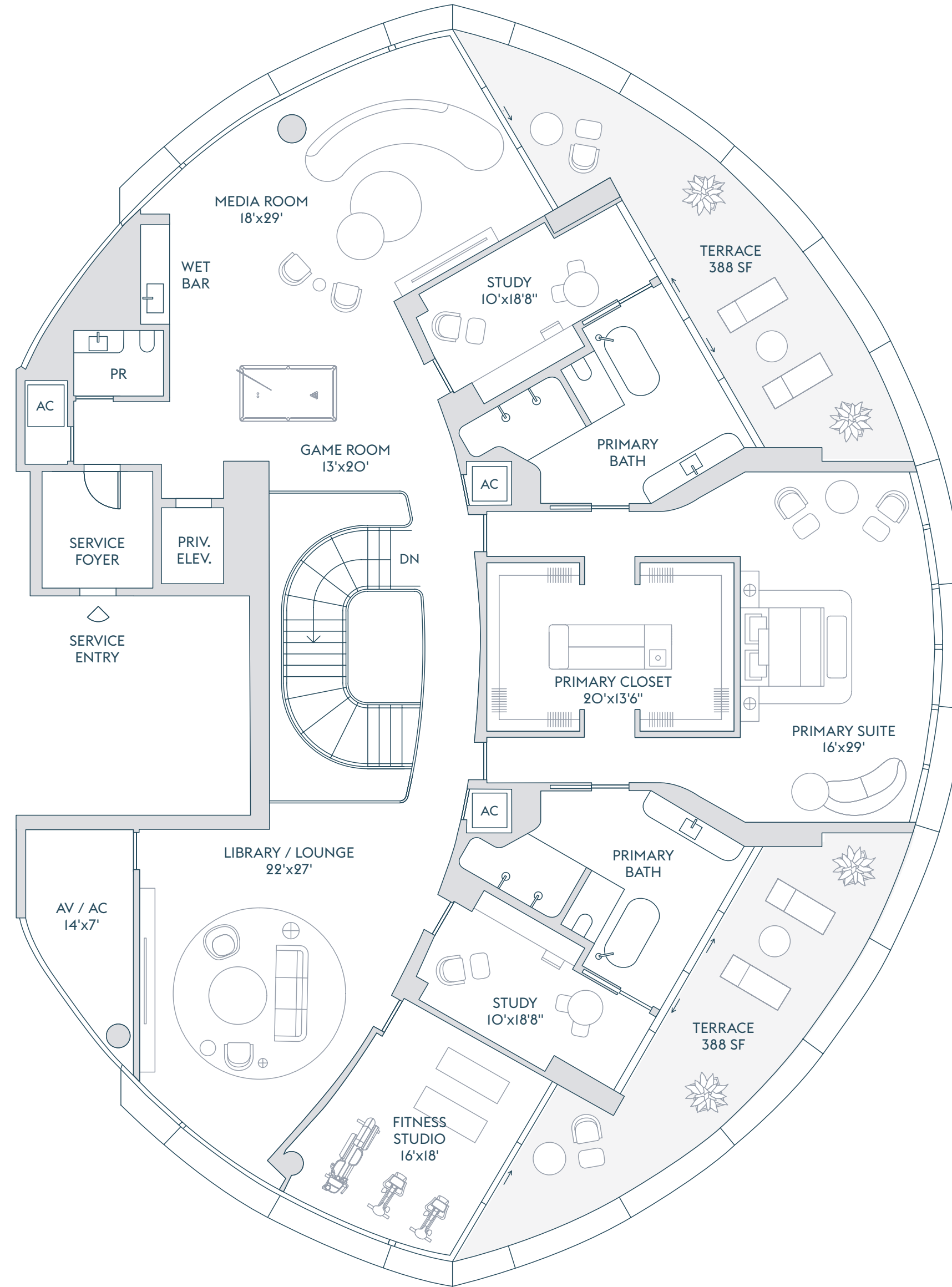

INTRACOASTAL  
WATERS

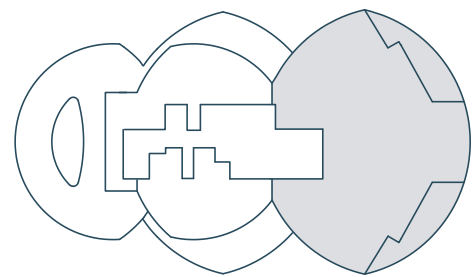

ATLANTIC OCEAN

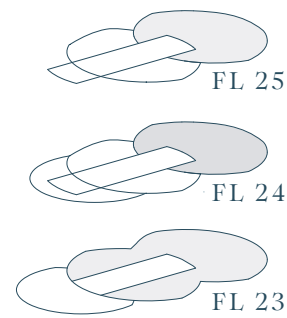

## FLOOR 24

The dimensions stated for this Unit floor plan are approximate because there are various recognized methods for calculating the square footage of a Unit. The square footage stated herein is calculated from the exterior boundaries of the exterior walls to the centerline of interior demising walls without deductions for cutouts, curves, or architectural features. This method typically results in quoted dimensions greater than the dimensions that would be determined by using other accepted methods. The definition of "Unit" and the calculation method to be relied upon is the method of calculation set forth by the Developer in the Developer's prospectus, which method may result in a square footage calculation that is less than the method used herein. Dimensions and Unit configurations are not guaranteed and may change during construction. Depictions of furnishings, fixtures, and other items of personal property are not included with purchase. Uses of space depicted are not guaranteed. Consult the Developer's prospectus to learn Unit dimensions, what is offered with the Unit, and all terms and conditions. 2022 © Carlton Terrace Owner LLC, with all rights reserved.

# A 23, 24, 25

- 5 BEDROOMS
- 7 BATHROOMS
- 3 POWDER ROOMS
- DEN / SERVICE
- MEDIA ROOM
- GAME ROOM
- LIBRARY / LOUNGE
- FITNESS STUDIO
- OUTDOOR KITCHEN
- POOL
- PRIVATE ELEVATOR

INTERIOR  
12,603 SF | 1,171 SQM

EXTERIOR  
4,918 SF | 457 SQM

TOTAL  
17,521 SF | 1,628 SQM

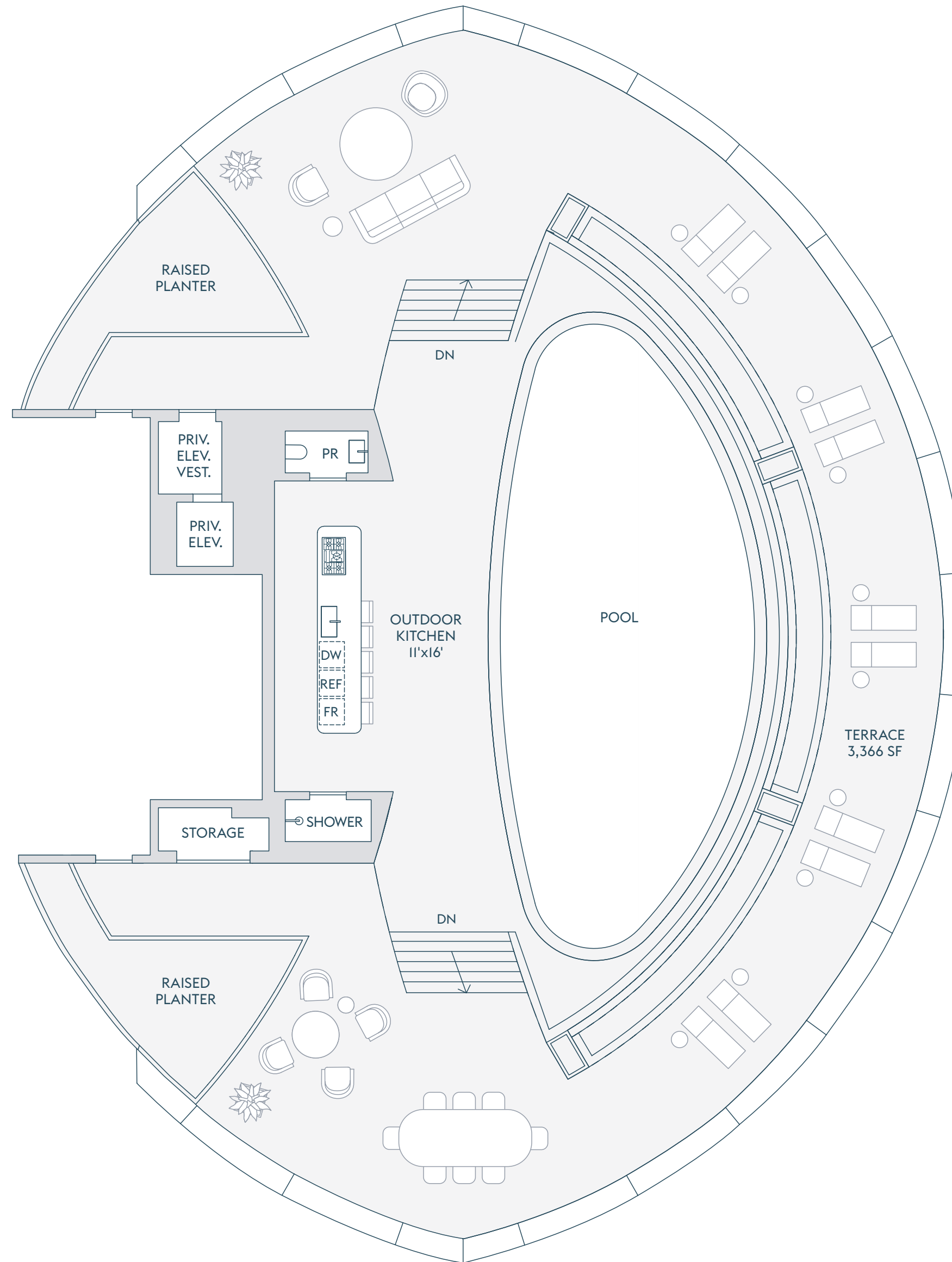

INTRACOASTAL  
WATERS

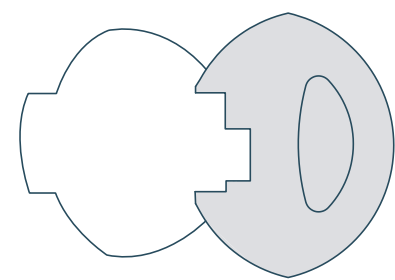

ATLANTIC OCEAN

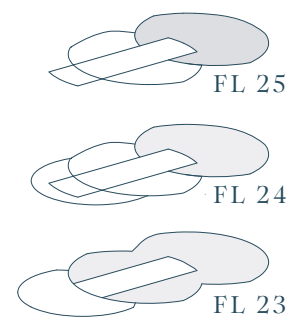

## FLOOR 25

The dimensions stated for this Unit floor plan are approximate because there are various recognized methods for calculating the square footage of a Unit. The square footage stated herein is calculated from the exterior boundaries of the exterior walls to the centerline of interior demising walls without deductions for cutouts, curves, or architectural features. This method typically results in quoted dimensions greater than the dimensions that would be determined by using other accepted methods. The definition of "Unit" and the calculation method to be relied upon is the method of calculation set forth by the Developer in the Developer's prospectus, which method may result in a square footage calculation that is less than the method used herein. Dimensions and Unit configurations are not guaranteed and may change during construction. Depictions of furnishings, fixtures, and other items of personal property are not included with purchase. Uses of space depicted are not guaranteed. Consult the Developer's prospectus to learn Unit dimensions, what is offered with the Unit, and all terms and conditions. 2022 © Carlton Terrace Owner LLC, with all rights reserved.



# C 22, 23, 24

- 5 BEDROOMS
- 9 BATHROOMS
- POWDER ROOM
- 2 DEN / SERVICE
- FAMILY ROOM
- FITNESS STUDIO
- SKY ROOM
- OUTDOOR KITCHEN
- POOL
- PRIVATE ELEVATOR

INTERIOR  
8,677 SF | 806 SQM

EXTERIOR  
4,928 SF | 458 SQM

TOTAL  
13,605 SF | 1,264 SQM

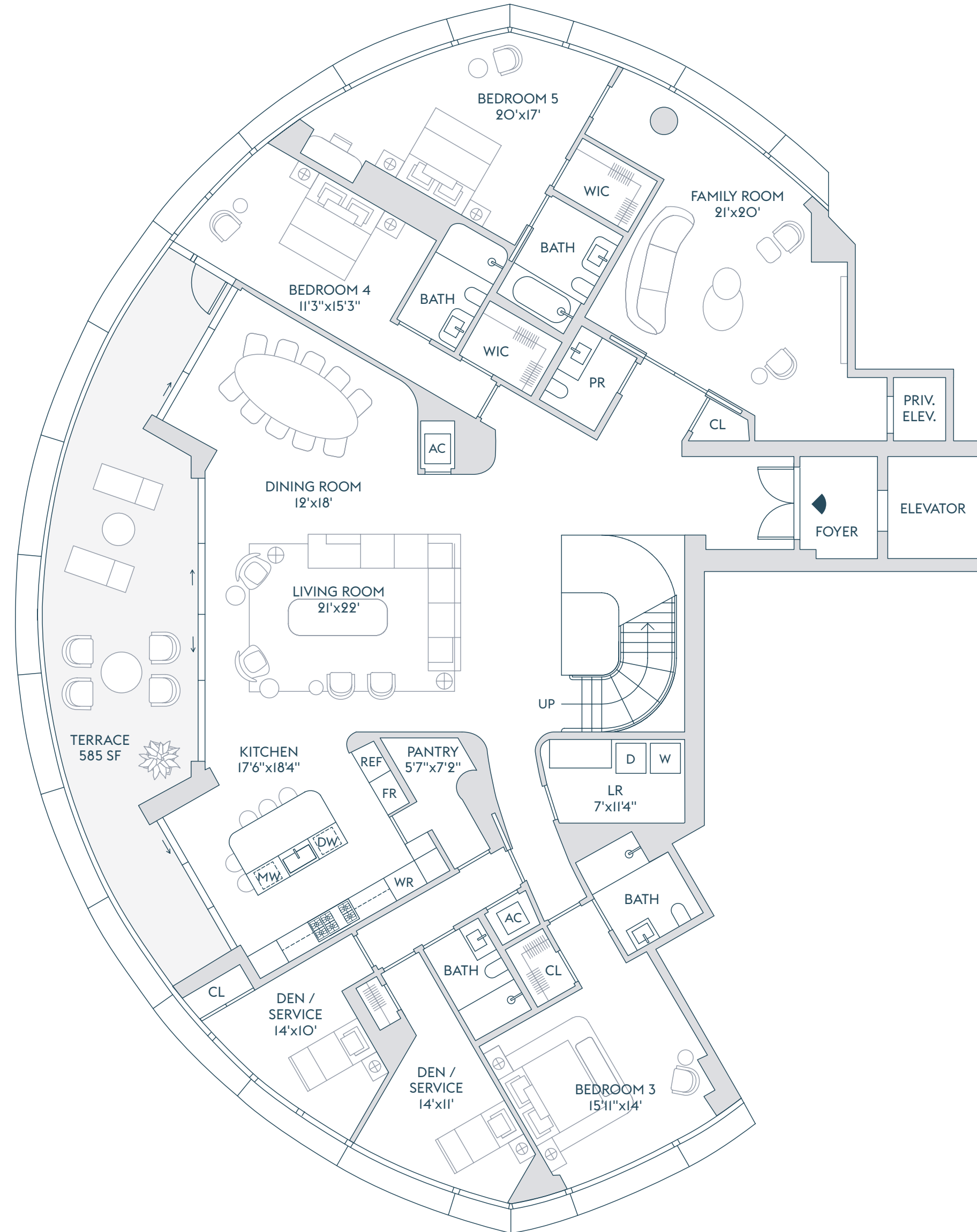

INTRACOASTAL  
WATERS

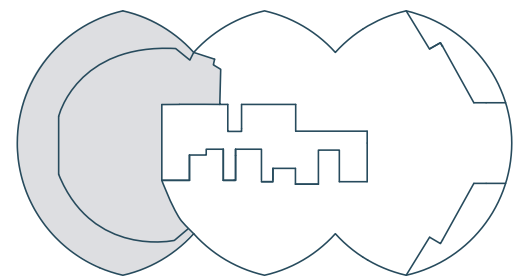

ATLANTIC OCEAN

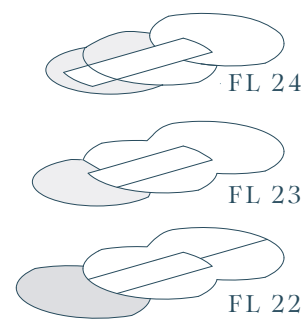

## FLOOR 22

The dimensions stated for this Unit floor plan are approximate because there are various recognized methods for calculating the square footage of a Unit. The square footage stated herein is calculated from the exterior boundaries of the exterior walls to the centerline of interior demising walls without deductions for cutouts, curves, or architectural features. This method typically results in quoted dimensions greater than the dimensions that would be determined by using other accepted methods. The definition of "Unit" and the calculation method to be relied upon is the method of calculation set forth by the Developer in the Developer's prospectus, which method may result in a square footage calculation that is less than the method used herein. Dimensions and Unit configurations are not guaranteed and may change during construction. Depictions of furnishings, fixtures, and other items of personal property are not included with purchase. Uses of space depicted are not guaranteed. Consult the Developer's prospectus to learn Unit dimensions, what is offered with the Unit, and all terms and conditions. 2022 © Carlton Terrace Owner LLC, with all rights reserved.



BAY  
PENTHOUSE FLOORS

# C 22, 23, 24

- 5 BEDROOMS
- 9 BATHROOMS
- POWDER ROOM
- 2 DEN / SERVICE
- FAMILY ROOM
- FITNESS STUDIO
- SKY ROOM
- OUTDOOR KITCHEN
- POOL
- PRIVATE ELEVATOR

INTERIOR  
8,677 SF | 806 SQM

EXTERIOR  
4,928 SF | 458 SQM

TOTAL  
13,605 SF | 1,264 SQM

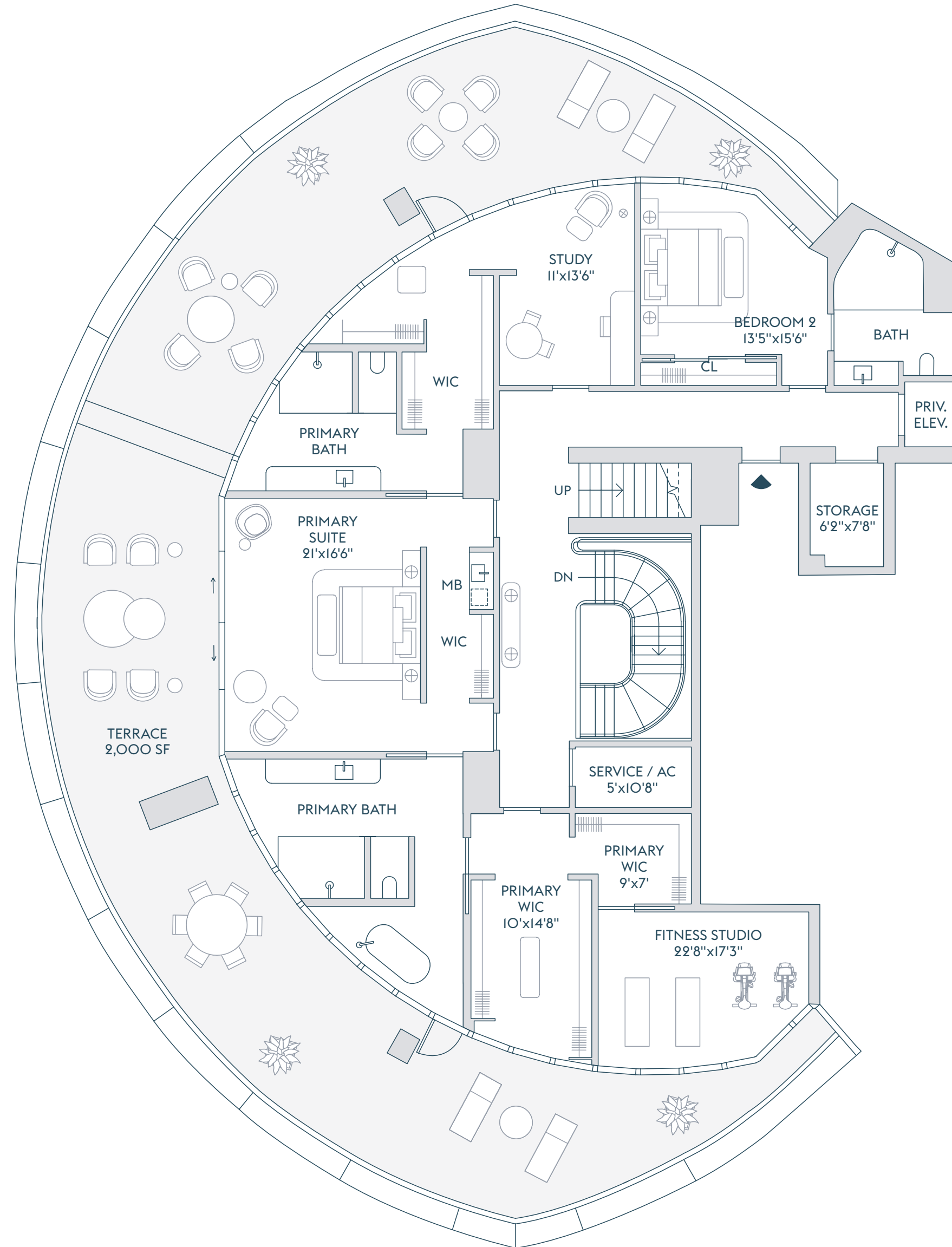

INTRACOASTAL  
WATERS

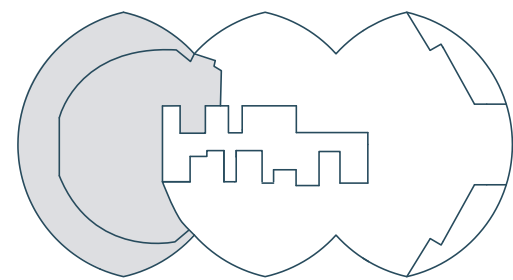

ATLANTIC OCEAN

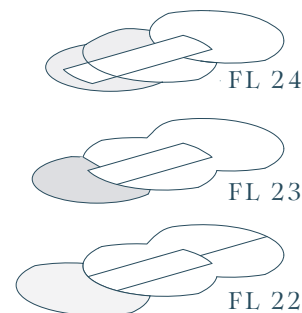

## FLOOR 23

The dimensions stated for this Unit floor plan are approximate because there are various recognized methods for calculating the square footage of a Unit. The square footage stated herein is calculated from the exterior boundaries of the exterior walls to the centerline of interior demising walls without deductions for cutouts, curves, or architectural features. This method typically results in quoted dimensions greater than the dimensions that would be determined by using other accepted methods. The definition of "Unit" and the calculation method to be relied upon is the method of calculation set forth by the Developer in the Developer's prospectus, which method may result in a square footage calculation that is less than the method used herein. Dimensions and Unit configurations are not guaranteed and may change during construction. Depictions of furnishings, fixtures, and other items of personal property are not included with purchase. Uses of space depicted are not guaranteed. Consult the Developer's prospectus to learn Unit dimensions, what is offered with the Unit, and all terms and conditions. 2022 © Carlton Terrace Owner LLC, with all rights reserved.

# C 22, 23, 24

- 5 BEDROOMS
- 9 BATHROOMS
- POWDER ROOM
- 2 DEN / SERVICE
- FAMILY ROOM
- FITNESS STUDIO
- SKY ROOM
- OUTDOOR KITCHEN
- POOL
- PRIVATE ELEVATOR

INTERIOR  
8,677 SF | 806 SQM

EXTERIOR  
4,928 SF | 458 SQM

TOTAL  
13,605 SF | 1,264 SQM

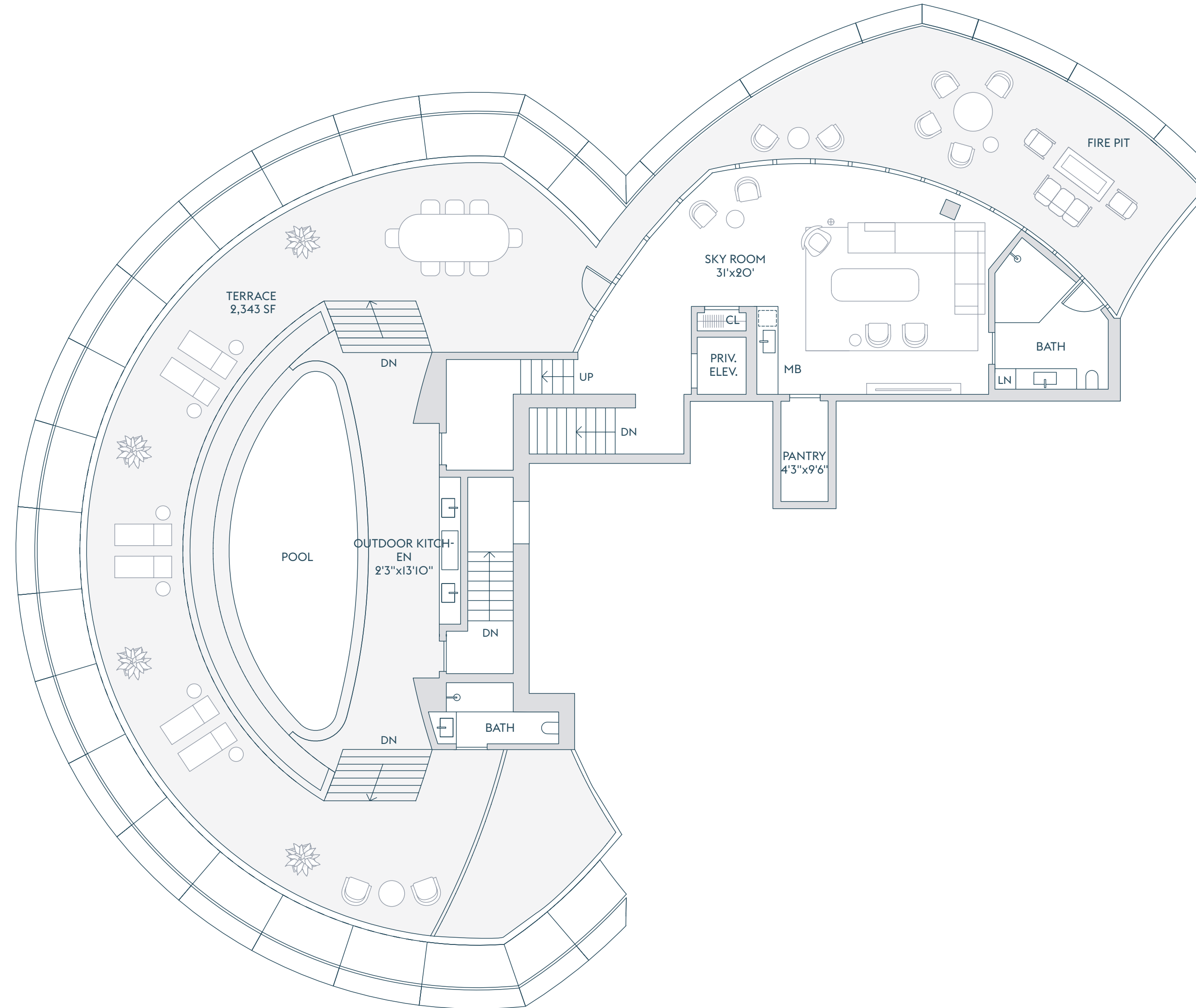

INTRACOASTAL  
WATERS

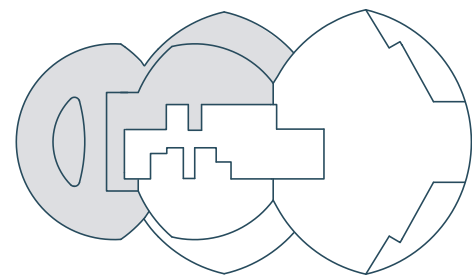

ATLANTIC OCEAN

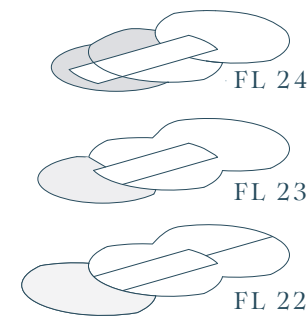

## FLOOR 24

The dimensions stated for this Unit floor plan are approximate because there are various recognized methods for calculating the square footage of a Unit. The square footage stated herein is calculated from the exterior boundaries of the exterior walls to the centerline of interior demising walls without deductions for cutouts, curves, or architectural features. This method typically results in quoted dimensions greater than the dimensions that would be determined by using other accepted methods. The definition of "Unit" and the calculation method to be relied upon is the method of calculation set forth by the Developer in the Developer's prospectus, which method may result in a square footage calculation that is less than the method used herein. Dimensions and Unit configurations are not guaranteed and may change during construction. Depictions of furnishings, fixtures, and other items of personal property are not included with purchase. Uses of space depicted are not guaranteed. Consult the Developer's prospectus to learn Unit dimensions, what is offered with the Unit, and all terms and conditions. 2022 © Carlton Terrace Owner LLC, with all rights reserved.

LOWER  
PENTHOUSE FLOORS

# A 22, 24

- 6 BEDROOMS
- 9 BATHROOMS
- 2 POWDER ROOMS
- DEN
- SERVICE
- FAMILY ROOM
- SKY ROOM
- WINE ROOM
- OUTDOOR KITCHEN
- SPA POOL
- PRIVATE ELEVATOR

INTERIOR  
9,464 SF | 879 SQM

EXTERIOR  
1,346 SF | 125 SQM

TOTAL  
10,810 SF | 1,004 SQM

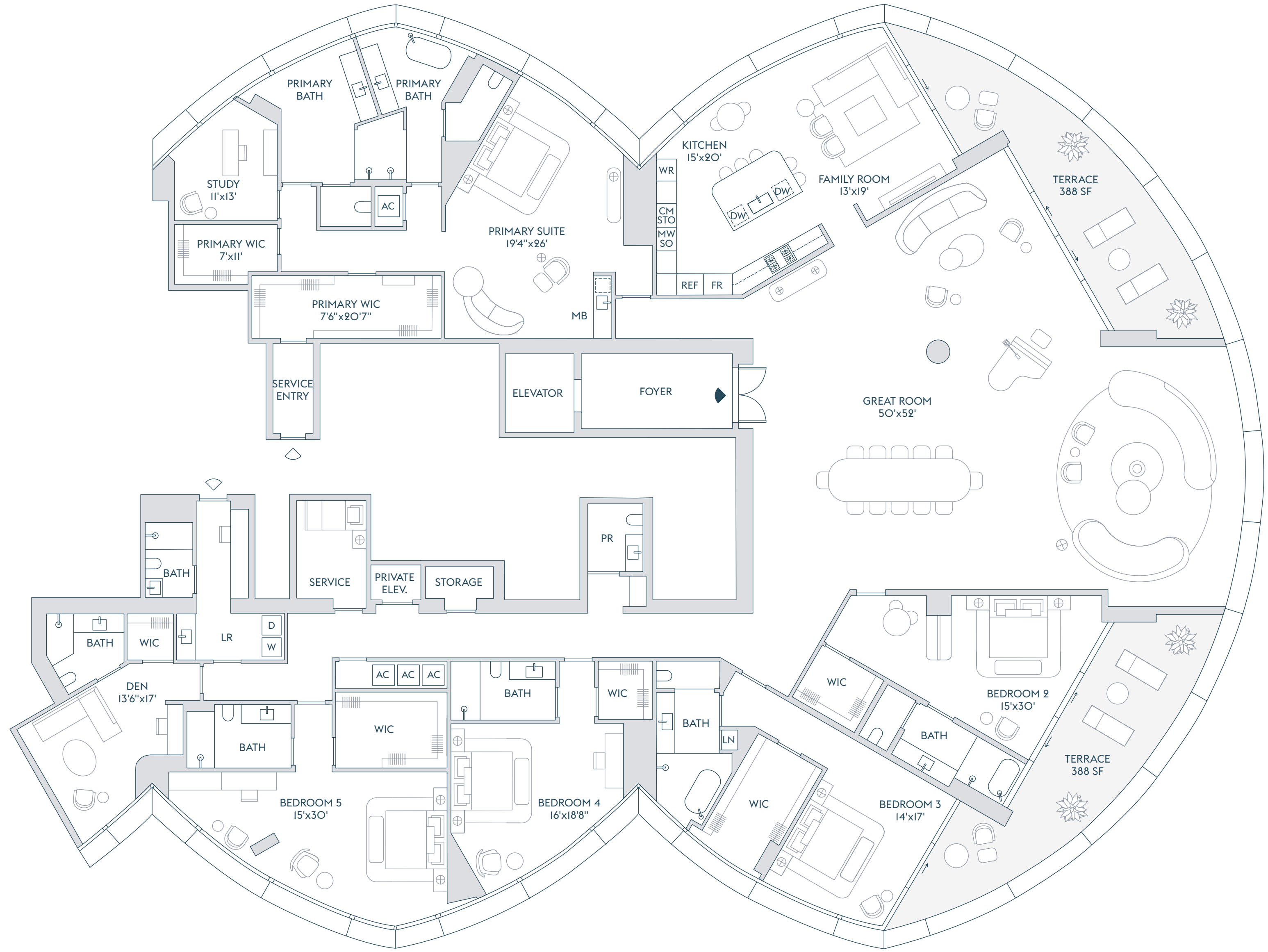

INTRACOASTAL  
WATERS

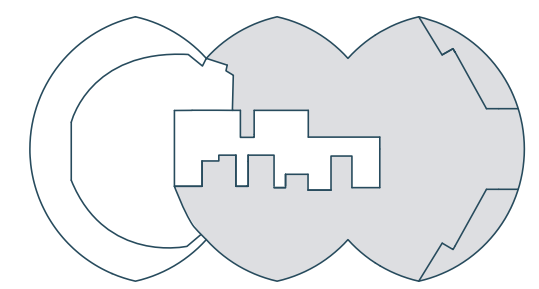

ATLANTIC OCEAN

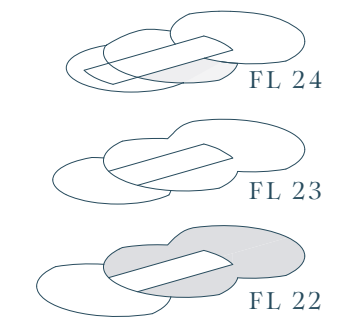

FLOOR 22

The dimensions stated for this Unit floor plan are approximate because there are various recognized methods for calculating the square footage of a Unit. The square footage stated herein is calculated from the exterior boundaries of the exterior walls to the centerline of interior demising walls without deductions for cutouts, curves, or architectural features. This method typically results in quoted dimensions greater than the dimensions that would be determined by using other accepted methods. The definition of "Unit" and the calculation method to be relied upon is the method of calculation set forth by the Developer in the Developer's prospectus, which method may result in a square footage calculation that is less than the method used herein. Dimensions and Unit configurations are not guaranteed and may change during construction. Depictions of furnishings, fixtures, and other items of personal property are not included with purchase. Uses of space depicted are not guaranteed. Consult the Developer's prospectus to learn Unit dimensions, what is offered with the Unit, and all terms and conditions. 2022 © Carlton Terrace Owner LLC, with all rights reserved.

LOWER  
PENTHOUSE FLOORS

# A 22, 24

- 6 BEDROOMS
- 9 BATHROOMS
- 2 POWDER ROOMS
- DEN
- SERVICE
- FAMILY ROOM
- SKY ROOM
- WINE ROOM
- OUTDOOR KITCHEN
- SPA POOL
- PRIVATE ELEVATOR

INTERIOR  
9,464 SF | 879 SQM

EXTERIOR  
1,346 SF | 125 SQM

TOTAL  
10,810 SF | 1,004 SQM

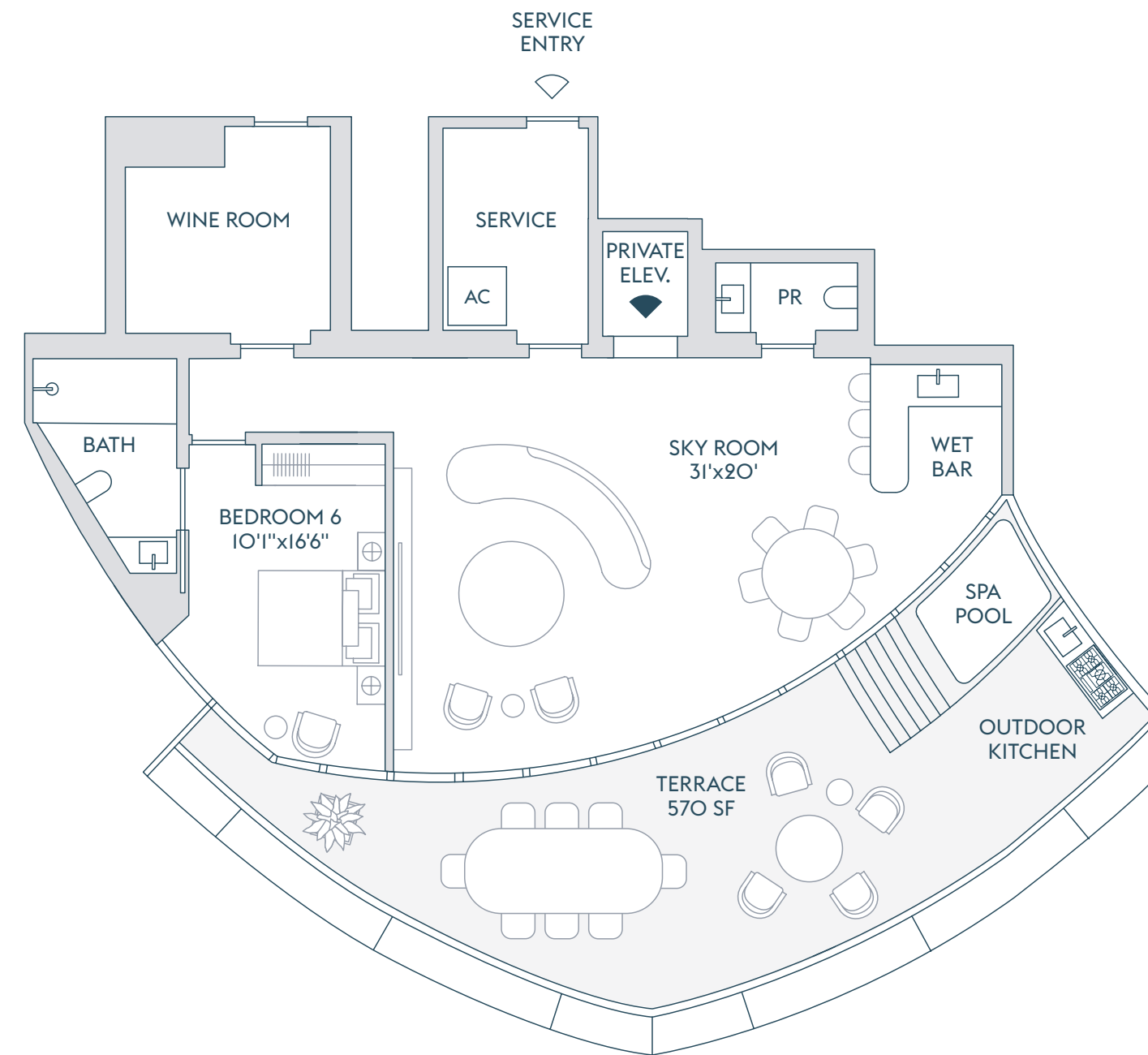

INTRACOASTAL  
WATERS

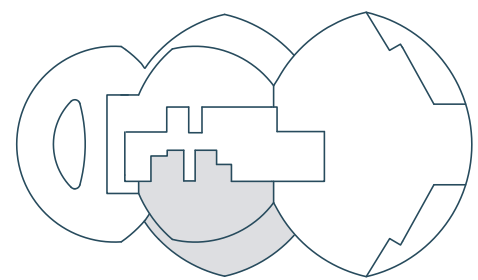

ATLANTIC OCEAN

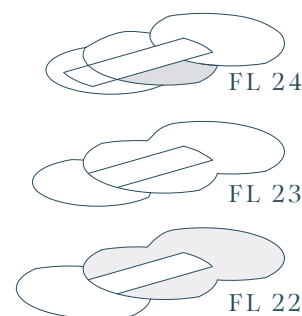

## FLOOR 24

The dimensions stated for this Unit floor plan are approximate because there are various recognized methods for calculating the square footage of a Unit. The square footage stated herein is calculated from the exterior boundaries of the exterior walls to the centerline of interior demising walls without deductions for cutouts, curves, or architectural features. This method typically results in quoted dimensions greater than the dimensions that would be determined by using other accepted methods. The definition of "Unit" and the calculation method to be relied upon is the method of calculation set forth by the Developer in the Developer's prospectus, which method may result in a square footage calculation that is less than the method used herein. Dimensions and Unit configurations are not guaranteed and may change during construction. Depictions of furnishings, fixtures, and other items of personal property are not included with purchase. Uses of space depicted are not guaranteed. Consult the Developer's prospectus to learn Unit dimensions, what is offered with the Unit, and all terms and conditions. 2022 © Carlton Terrace Owner LLC, with all rights reserved.